

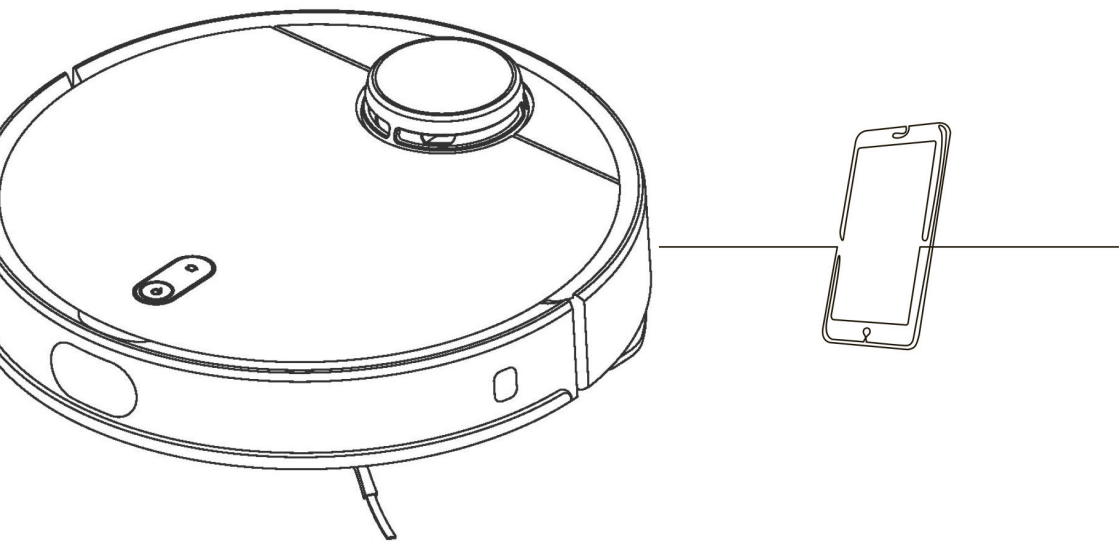

**T-BOT**  
smart home cleaning



<b>QUICK START</b>	<b>4</b>
<b>PROFILE SETTINGS</b>	<b>8</b>
<b>CREATING MAPS</b>	<b>9</b>
<b>MODES &amp; AREAS</b>	<b>10</b>
<b>SETTINGS</b>	<b>14</b>
<b>MESSAGES</b>	<b>17</b>
<b>TROUBLESHOOTING</b>	<b>18</b>
<b>HELP &amp; CONTACT</b>	<b>19</b>

1. Download the „Trisa T-Bot“ app from the Apple or Google Play Store
2. Enter your e-mail address & choose your desired password
3. Check your e-mails (also the spam folder). Sender: Slamtec, RoboCloud
4. Enter the received 6-digit code into the app
5. Make sure that the unit is switched on and the LED indicator is blinking

**Register**

We're glad you're here, new RoboCloud user!

RoboCloud provides unified cloud service and user account management for various kind of robot devices and users.

To activate your account, please use the code below in your APP. If you didn't register this account, please ignore this email.

864252

This code will expire in 24 hours, so be sure to use it right away.

864252

OK

Send activation mail again (23)

GET IT ON Google Play

Download on the App Store

**Downloads & Links**

trisaelectronics.ch/t-bot

6. Add a new device and follow the instructions

My Devices

Add new device

Add new device

Add new device

Please make sure the bluetooth and the location enabled.

Please press and hold the power button and the HOME button on the device until you hear a voice that the device reports "Wi-Fi is reset". Then press the "Next" button to continue.

Please ensure your device is in the pre-configure mode.

The state LED is not flashing?

7. Select the displayed device

8. Make sure your Wi-Fi is switched on and to select the right one
9. Enter your current Wi-Fi password

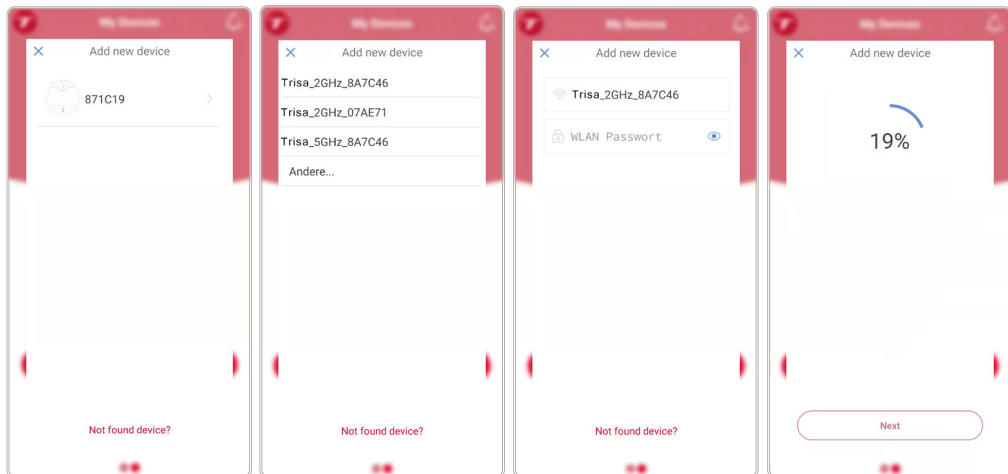

10. After a successful connection, return to the start screen

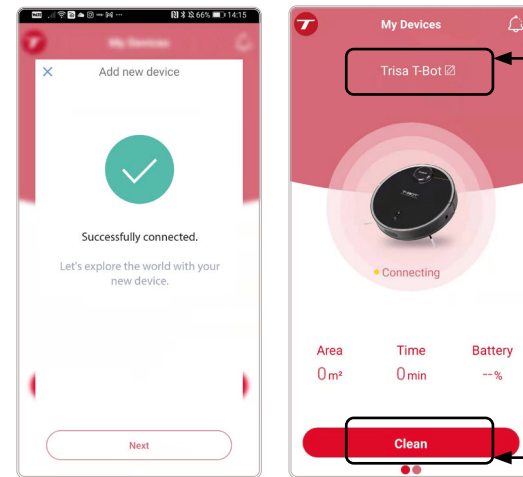

11. Give your device an individual name

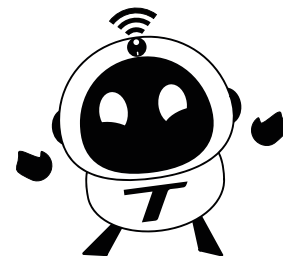

12. Start the cleaning process

**If you have any problems connecting to the robot, check your Wi-Fi connection and password. Uninstall and reinstall the app if necessary. Press the Power and HOME buttons at the same time.**

The app can be personalised in the profile settings. Upload your own picture, enter various personal details or delete your account if you no longer want the T-Bot to be controlled by you.

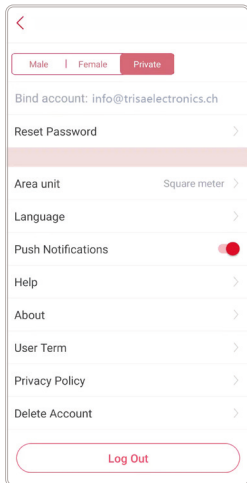
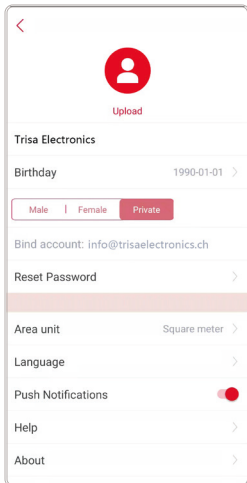

The unit of area is set in square metres by default. If this is not the case or you prefer to work in square feet, you can change the setting.

There are over 15 languages available for the app so far, making it even easier for you to using it. Deactivate „Messages“ nto stop receiving push messages.

When the T-Bot is used for the first time, let it clean the rooms by itself. It will create a map automatically. You can save up to six maps for several floors.

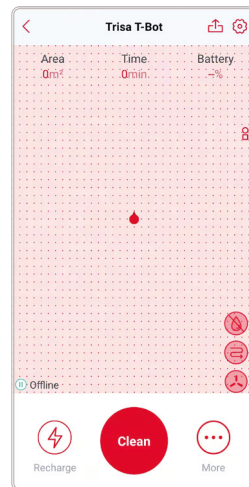

Depending on which floor the T-Bot currently is, select the corresponding map  and choose the desired cleaning procedure before you let it start its work.

To delete maps, select „Clear Map“ in the same list and let the T-Bot discover another area.

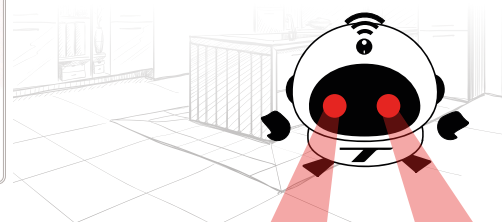



The T-Bot offers several functions that optimise the way of cleaning your floors. Set exactly when, where, how much, how often or with which suction power the unit has to vacuum.

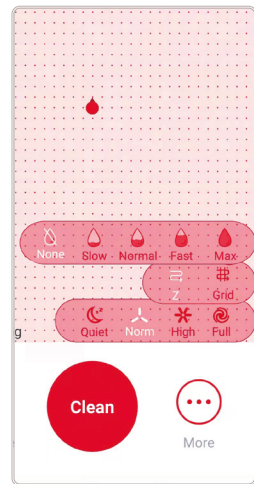

The T-Bot can also mop your floors if desired. Once you have attached the water tank and the mop, select the amount of water and the areas / rooms it has to clean particularly thoroughly.



Define the way of the cleaning path. Should the T-Bot only move in serpentine lines or with a hashtag pattern ?



The suction power of the robot has an effect on its volume. For heavily soiled floors or carpets, full suction power is recommended. At night, a low, quiet level is perfect to get enough sleep.



Cleaning areas can be set under „More“ or in the app settings.

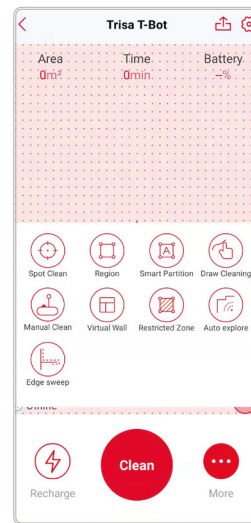

A specific location of 1m<sup>2</sup> will be cleaned.

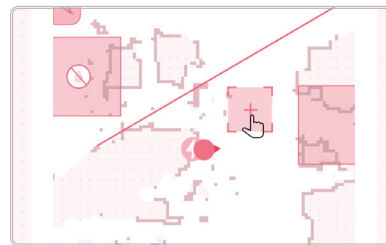

The vacuum cleaner will learn and divide your house into several areas (see p. 15).



You can draw paths in this mode and order the T-Bot to clean along the paths.\*



If some places need to be cleaned frequently, create specific regions, you can send the bot to do its work.

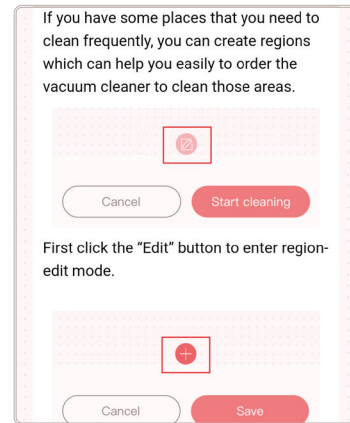

If you have some places that you need to clean frequently, you can create regions which can help you easily to order the vacuum cleaner to clean those areas.

First click the "Edit" button to enter region-edit mode.



Manually navigate the T-Bot through the room.

**Manual Clean**

You can control the vacuum cleaner manually to clean where you want.

Recharge

Back

In this mode, you can order the vacuum cleaner to forward, backward, turn left, turn right.

**BE CAREFUL!**  
Please keep the vacuum cleaner in your sight. It will execute your order directly and it won't dodge obstacles by itself. You have full control on its movement.

OK

Create virtual walls, the T-Bot cannot pass, if you don't want a specific room to be cleaned.

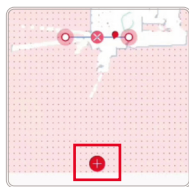
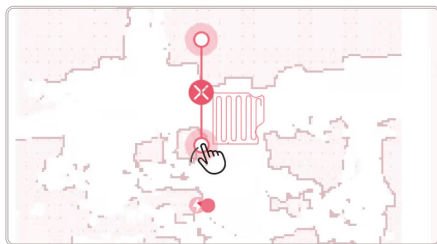

Define restricted regions, you don't want to be swept or mopped.

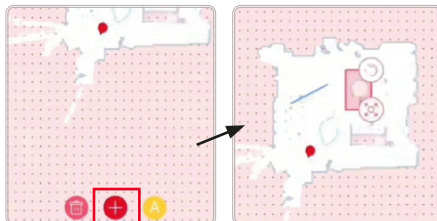

If carpet detection is activated, the T-Bot automatically reduces or increases its suction power when switching from hard floors to carpets. This can also be set in the settings.

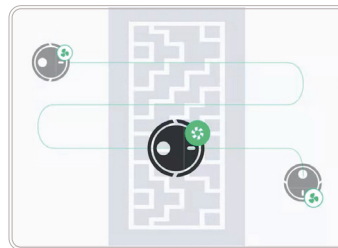
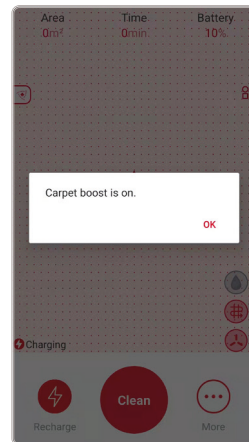

Send the T-Bot back to the charging station for recharging by tapping this symbol.

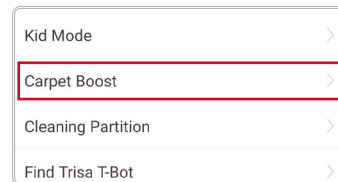

\* In the „Draw Cleaning“ mode, you can draw creative cleaning paths completely freely. Share fun creations with friends on social media, via WhatsApp, e-mail and other platforms.





In the settings section, you can download the latest software version or learn when to replace the spare parts. You can also choose in which language the T-Bot should talk to you and turn the volume up or down.

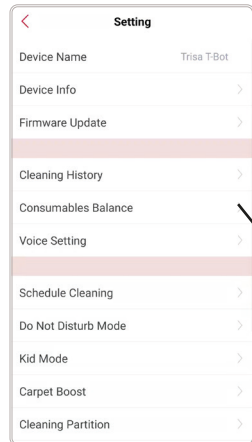

Create individual schedules and set different cleaning times. The T-Bot will start working on its own. You can let it clean the entire map or only certain zones and partitions.

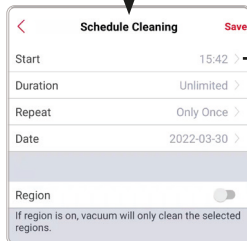
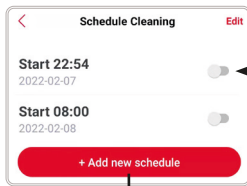
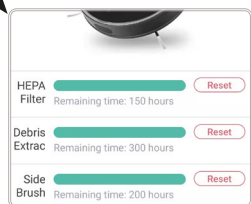

If you want to have your home cleaned at night, with help of the cleaning schedule, it is recommended to choose „Do not disturb“ mode. This way the T-Bot will stop talking to you and will work as quietly as possible.

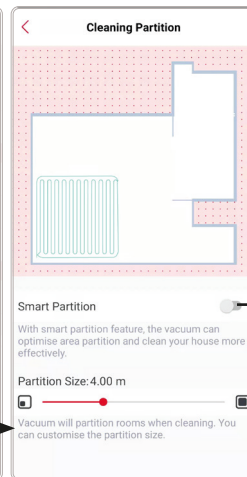
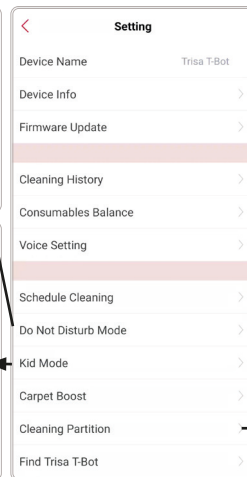
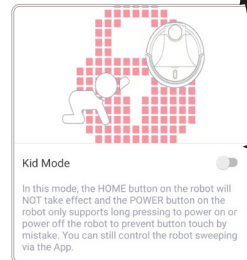
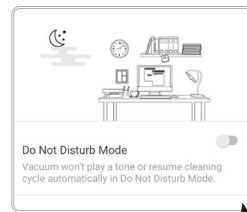



Manage or delete your maps in the settings and get an overview of all existing and deleted versions.

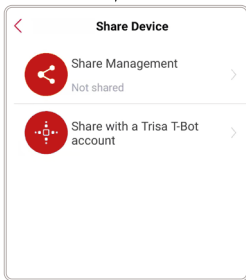
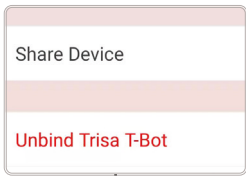

Share your T-Bot account and share rights to allow other users to access your device and use your maps.

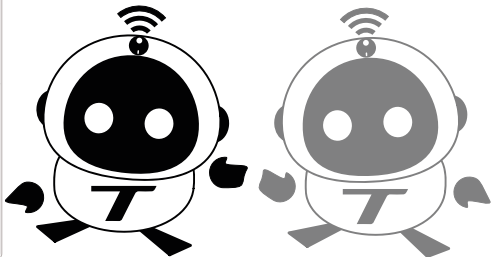

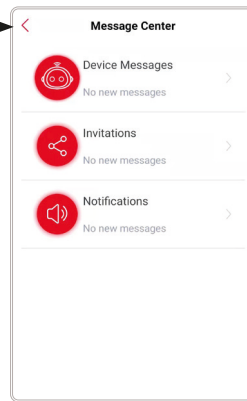

The message center displays all notifications and alerts reported by the T-Bot. You can also share the vacuum cleaner and its maps by sending invitations. A red dot will appear on the bell, which shows new messages. Open the invitation and accept it to receive the rights to use the T-Bot from another user. Changes are immediately displayed for all invited users.





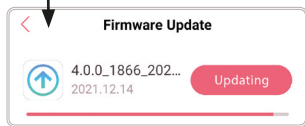
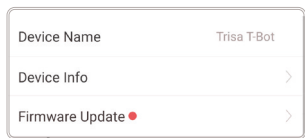

If you experience any problems with our App or connectivity to the T-Bot, please check first whether a new firmware is available.

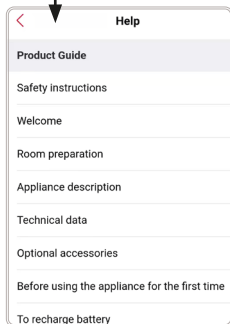
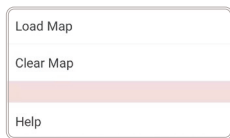

Also check your messages  for error notes. The T-Bot detects certain problems with the device itself.



In the settings  under „Help“ you will find our digital manual as well as some explainer videos on how to use the app and the T-Bot.

If problems persist, delete the app completely from your device and reinstall it. Your data will be retained if you log in with the same login details. However, to be on the safe side, share them with someone first.

If you have any problems or questions about the T-Bot and its App, please contact Trisa Electronics before contacting your retailer.

## Opening hours of Trisa Electronics

Mo-Fr: 08:00 - 11:45 Uhr  
13:30 - 17:00 Uhr

**Trisa Electronics AG**  
**Kantonsstrasse 121**  
**CH-6234 Triengen**  
**info@trisaelectronics.ch**  
**+41 41 933 00 30**

You can find more information, links and downloads of our digital manuals at [www.trisaelectronics.ch/t-bot](http://www.trisaelectronics.ch/t-bot)

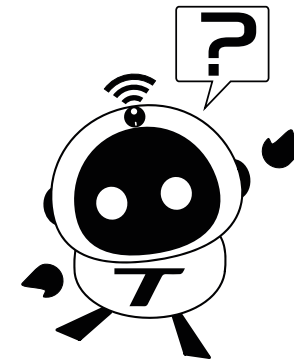

***Trisa***®  
E L E C T R O N I C S