

**5 YEARS**  
GUARANTEE



Refreshing slushies, cold drinks and creamy soft-serve ice cream - Quick and easy to prepare.

**Use:** Page 9



Slushies, drinks and soft-serve ice cream at your fingertips with simple ingredients.

**Recipes:** Page 11

# Welcome



**Please read all the information contained in these instructions for use. Keep the instructions for use in a safe place and pass them on to subsequent users. The device may only be used for its intended purpose in accordance with these instructions. Observe the safety instructions. The device is best operated with an RCD circuit breaker (max. 30mA).**



Complies with the European directives on safety and EMC.

We reserve the right to make changes to the design, equipment and specifications. Errors and omissions excepted.



**Spare parts and accessories shop**

<https://www.trisaelectronics.ch/en/zubehoer/>

# Table of Contents

<b>Safety instructions</b>	<b>4</b>	<b>Recipes</b>	<b>11</b>
<b>Specifications</b>	<b>5</b>	<b>Cleaning</b>	<b>12</b>
<b>Appliance overview</b>	<b>6</b>	<b>Problem and causes</b>	<b>14</b>
<b>Getting started</b>	<b>7</b>	<b>User information</b>	<b>16</b>
<b>Use</b>	<b>9</b>		

# Safety instructions

- Read all safety instructions, observe the instructions for use, keep them in a safe place and pass them on to subsequent users.
- Children aged 8 years and above and persons with reduced physical, sensory or mental capabilities, or lack of experience and knowledge, may only use the device if they are supervised by a person responsible for their safety or if they have been shown how to use the device safely and understand the dangers involved. Cleaning and maintenance work must not be carried out by children without supervision.
- Not for household waste. The device must be disposed of in accordance with local regulations.
- If the device is misused, operated incorrectly or repaired improperly, no liability can be accepted for any damage that occurs. In this case, the warranty claim is void.
- Never immerse the device in water or other liquids. No liquid must be allowed to enter the interior of the device (risk of short circuit).
- Check the device, power cord and extension cord for damage before each use. Never use damaged devices (including power cords) – have them repaired or replaced by the manufacturer, its service centre or qualified specialists. Never open the device yourself – risk of injury!
- Do not insert fingers or objects into device openings. Do not cover device openings.
- Avoid operating the device in the vicinity of flammable vapours.
- Children must not play with the device. Keep the device and power cord away from children under 8 years of age. Never leave the device unattended during operation. Packaging material (e.g. plastic bags) must be kept out of the reach of children.
- Mains connection: The voltage must correspond to the specifications on the device's type plate.

- Never carry or pull the device by the power cord. Do not kink, pinch or pull the power cord over sharp edges. Risk of short circuit due to cable breakage!



Never use near water (baths, sinks, etc.). Do not expose to rain or moisture. Only use the device with dry hands! If the device falls into water, have it checked by a specialist before using it again.

- Never place the device/connection cable on hot surfaces (hotplates) or near open flames. Do not expose the device to intense heat (heating sources, radiators, sunlight). Only extinguish burning devices with a fire blanket.
- Never pull the plug on the power cord or with wet hands. Unplug the device in the event of malfunctions during use, before refilling, before cleaning, before moving or after use. The plug must remain accessible at all times.
- Switch off unused/unattended devices and pull out the mains plug. Do not wrap the mains cable around the device.
- Only operate the device on a flat, stable, dry surface. Never attach it to a wall or ceiling.
- The appliance is intended for domestic use, not for commercial use.
- Do not operate/connect the appliance to a timer or remote-controlled switch.
- For safety reasons, do not use accessories that are not recommended/sold by the manufacturer.



**Protection class I — with protective conductor:** This appliance complies with protection class I. It must be connected to a socket with a protective conductor (earthed socket).



This appliance contains a flammable, highly combustible refrigerant.

- The refrigerator/freezer is suitable for loading and unloading by children aged 3 to 8.
- If the refrigerator/freezer has been empty for an extended period of time, switch off the appliance, defrost it, clean it, dry it and leave it open to prevent formation of mould.
- Surfaces that come into contact with food should be cleaned thoroughly after use in accordance with the cleaning instructions.

# Specifications

## Art. 7773.75

**220–240 V**  
**50 Hz**

Input voltage

**Min. 0.5 l**  
**Max. 2 l**

Container capacity

**ST**  
**+16 to +38 °C**

Climate class,  
Operating temperature

**1 m**

Cable length

**R290**  
**A3**

Refrigerant,  
Classification

**I**

Protection class

**Approx. 9.5 kg**

Weight (net)

**44 × 15 × 42**

Dimensions  
(cm)

## Power consumption

**250 W**

When ON

**0.5 W**

When OFF

**10 min**

OFF/Standby mode active  
after

# Appliance overview

Mixing auger

Cooling unit

Sealing ring

## Modes:



Slush  
For mixed drinks, fruit juices or sweet drinks



Spiked Slush  
For alcoholic slushies



Milkshake  
Creamy milk drinks



Soft Ice  
Soft-serve ice cream



Iced Drink (not as thick as a slushie)  
Fruit juices or sweet drinks



Rinse  
Rinses and empties without cooling

Container

Filler opening

Dispensing lever

Container release

Drawer

Dispensing spout with fitting for soft-serve ice cream

Cooling capacity

On/Off

Drip tray

Mains plug / cable

Cleaning brush

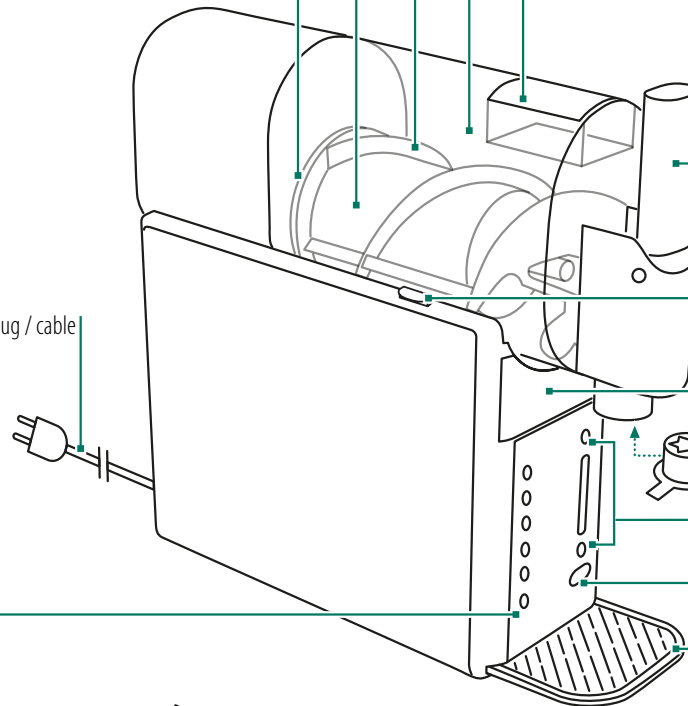

Spare parts and accessories shop

<https://www.trisaelectronics.ch/en/zubehoer/>

# Getting started

## 1. Set up

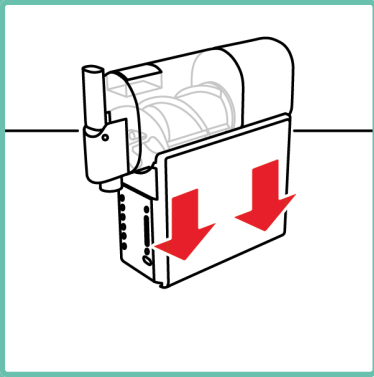

Remove all packaging, set the appliance up on a level surface.

- ! Keep packaging material away from children and dispose of properly.

## 2. Let appliance settle

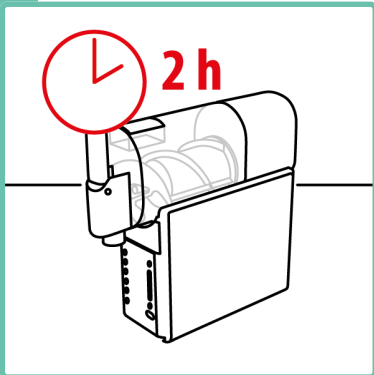

Leave in the operating position for 2 hours to allow the refrigerant to settle in the system.

- ! Applies before first use, after transport or if the appliance has not been stored horizontally.

## 3. Remove container

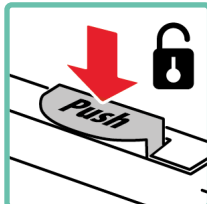
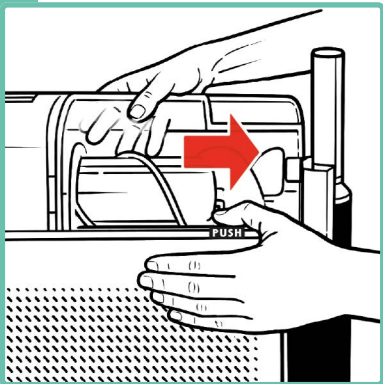

Release and pull out the container.

- ! Do not pull on the dispensing lever to remove the container!

## 4. Remove mixing auger

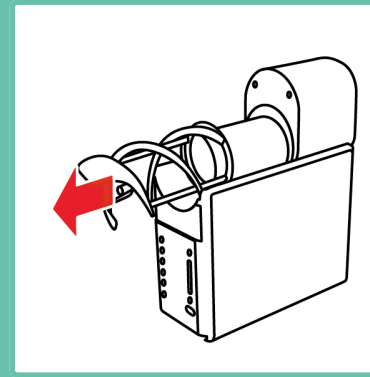

Pull the mixing auger out of the cooling unit.

## 5. Remove sealing ring

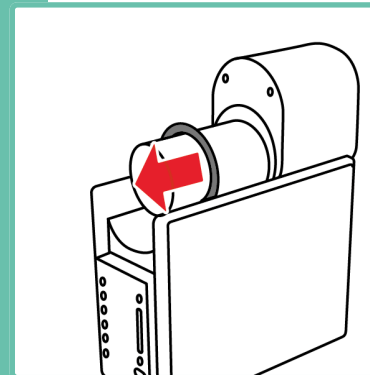

Pull the sealing ring off the cooling unit.

## 6. Pull out drawer

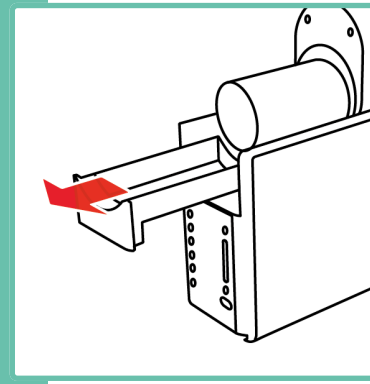

## 7. Clean accessories

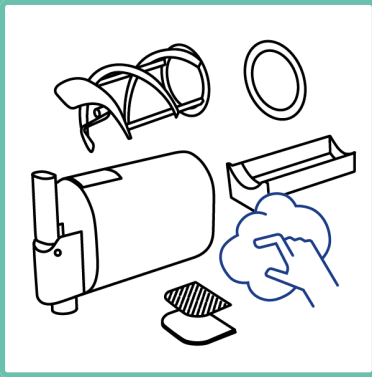

Wash the accessories under running water and with dishwashing liquid.

! Do not use anything abrasive!

## 8. Wipe off housing

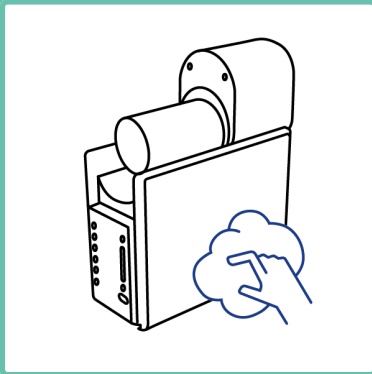

Wipe off the housing with a damp cloth.

! Never immerse the housing in water or hold it under running water.

## 9. Fit the drip tray and drawer

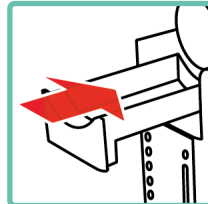
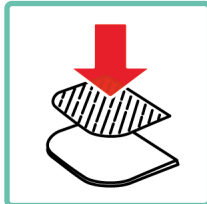
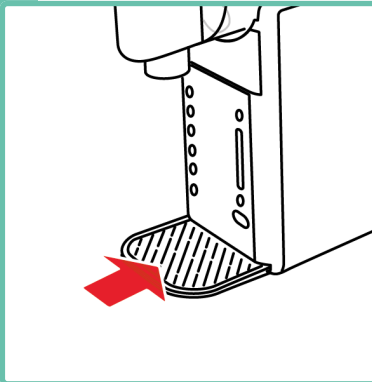

Place the rack into the bowl and attach the bowl to the housing. Fit the drawer.

## 10. Fit the sealing ring

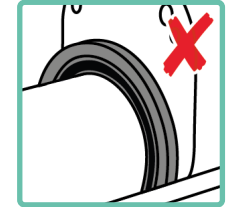
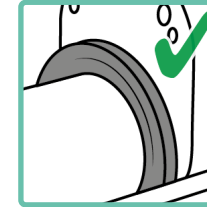
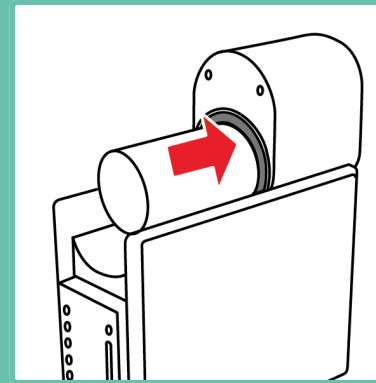

Slide the sealing ring onto the heat sink as far as it will go.

! Ensure the sealing ring is correctly aligned: **flatter side facing forwards, grooved side facing backwards.**

## 11. Fitting the auger mixer

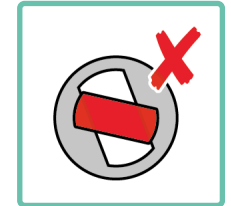
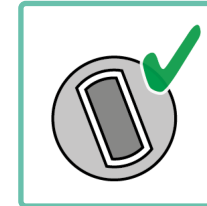
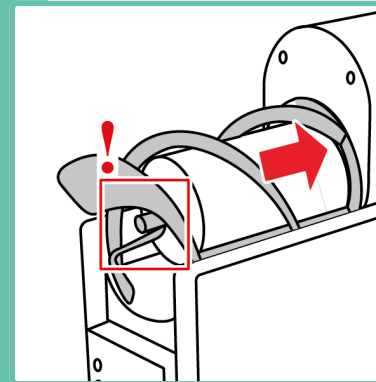

Slide the auger mixer onto the heat sink.

! Align the coupling correctly and engage it. The mixer is not engaged if it can be turned without resistance.

## 12. Fit the container

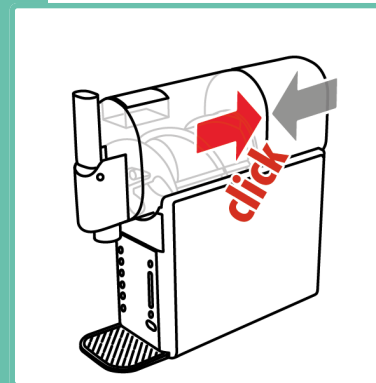

Snap the container into place until you hear a **click**.

# Use

## 1. Position appliance

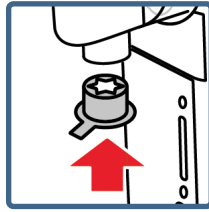
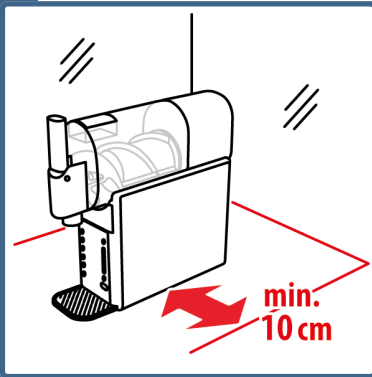

Observe the minimum clearance from walls and surroundings  
i If you are making soft-serve ice cream, insert the fitting into the dispensing spout.

## 2. Pour drink in

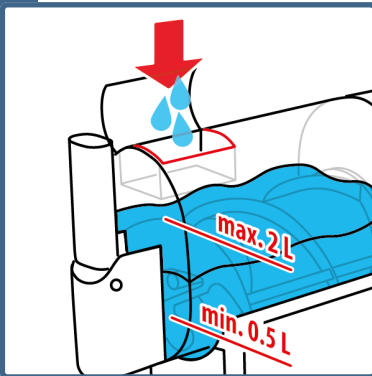

Pour the drink into the container through the filler opening.  
! No ice cubes, no solid fruit, no frozen fruit, no liquids with chunks/bits, no hot ingredients.  
i Syrup or soft drinks are great for making slushies.

## 3. Plug appliance in

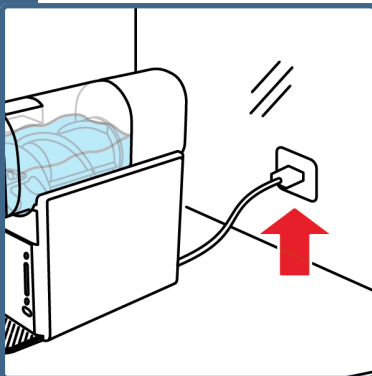

Plug in the appliance and switch it on.

## Start programme



### Slush

Programme for slushies made from syrup or fruit drinks with more than 10% sugar content.



### Spiked Slush

Programme for alcoholic slushies (3% - 16% alcohol) made with cider, wine-based mixes, premixed cocktails or similar. Stronger mixtures must be watered down.



### Milkshake

Programme for creamy milkshakes. Depending on the recipe, puree the ingredients first, then add them to the container.



### Soft Ice

Programme for soft-serve ice cream up to a maximum of 1.2 litres. The ice cream recipe should contain a high proportion of sugar, milk and/or full cream so that the consistency remains creamy and the soft-serve ice cream can be dispensed.

**Note:** Use the soft-serve ice cream fitting with this programme.

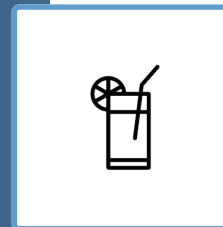

### Iced Drink

Programme for cold drinks such as juice, lemonade or other cold mixed drinks. The appliance cools the drinks down quickly and is suitable for quantities of 0.5 to 2.0 litres.

## 4. Adjust cooling level if required

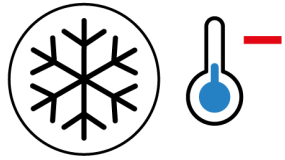

**Higher cooling level** = harder and more ice crystals

**Lower cooling level** = less thick consistency

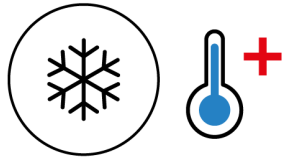

**i** Depending on how cold the ingredients are when you add them, you may need to run the programme twice to achieve the consistency you want.

**i** When the programme finishes, the button of the selected programme flashes. The appliance keeps cooling and mixing to keep the drink/dessert at the right consistency.

## 5. Dispense drink/dessert



Pull the dispensing lever to dispense the drink/dessert.

**i** The mixture will freeze quickly if there is less than 500 ml left in the container - you should pour it out without delay.

**!** Empty the entire container after use. See Cleaning on page 12.

# Recipes

## Pinky Slushie



- 1800 ml pink grapefruit lemonade
- 100 ml pomegranate juice
- 100 ml lime/lemon juice

1. Pour everything into the container.
2. Select the **Slush** programme.

i

### *Optional (according to taste):*

*- Leave rosemary in the lemonade overnight to let it infuse.*

*- Replace the pomegranate juice with syrup (e.g. raspberry) and leave out the lime/lemon juice if you want a sweeter flavour.*

## Iccicino



- 300 ml whole milk
- 150 ml cream
- 900 ml black coffee (cold)
- 1.5 tsp vanilla extract
- 10-12 tbsps sugar

1. Dissolve the sugar in the warm coffee and chill overnight in the fridge.
2. Pour everything into the container.
3. Select the **Milkshake** programme.

i

*It will take approx. 50 minutes to process 1.5 litres and less time for smaller quantities.*

## Soft-serve vanilla ice cream



- 500 ml whole milk
- 500 ml full cream
- 150 g sugar
- 2-3 tsp vanilla extract or
- 2 sachets of vanilla sugar

1. Mix the ingredients together well in a measuring jug.
2. Pour everything into the container.
3. Select the **Soft Ice** programme.

i

*It will take approx. 45 minutes to process 1.2 litres and less time for smaller quantities.*

## More recipes



[www.trisaelectronics.ch/de/ueberuns/rezepte/](http://www.trisaelectronics.ch/de/ueberuns/rezepte/)

# Cleaning

## 1. Empty appliance

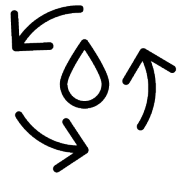

Rinse



Start the Rinse programme and open the spout to completely empty the container.

- ! Empty the leftover mixture directly into a sink or put a large container under the dispensing spout.
- i Plug the appliance in beforehand and switch it on (Start button).

## 2. Rinse container

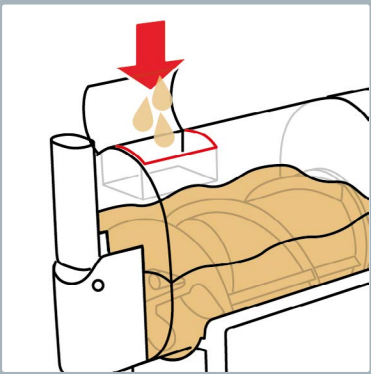

Pour 2 litres of lukewarm water into the container, then run the Rinse programme until any leftover mixture in the container has dissolved.

## 3. Rinse again

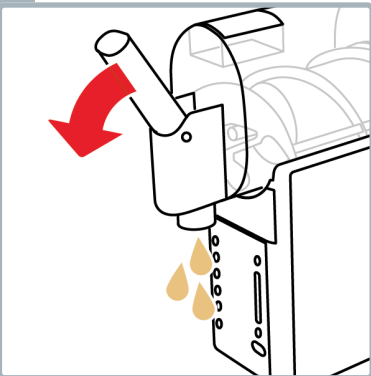

Open the dispensing spout again to completely empty the container.

- ! Empty the leftover mixture directly into a sink or put a large container under the dispensing spout.

## 4. Switch appliance off

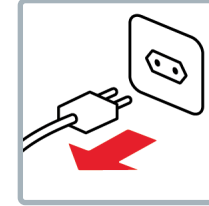
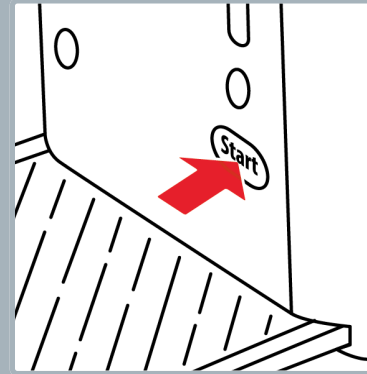

Switch off and unplug the appliance.

- ! Do not unplug it until the fan in the appliance has stopped.

## 5. Remove container

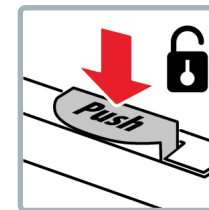
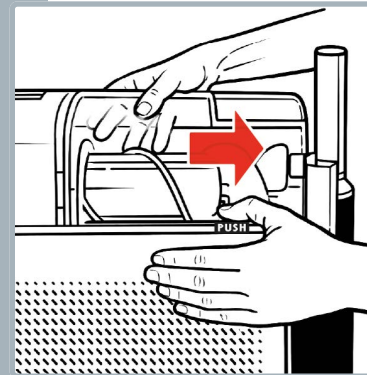

Release and pull out the container.

- ! Do not pull on the dispensing lever to remove the container!

## 6. Remove mixing auger

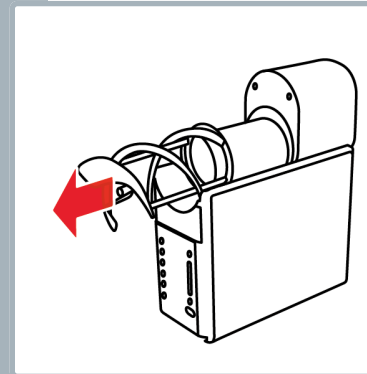

Pull the mixing auger out of the cooling unit.

## 7. Remove sealing ring

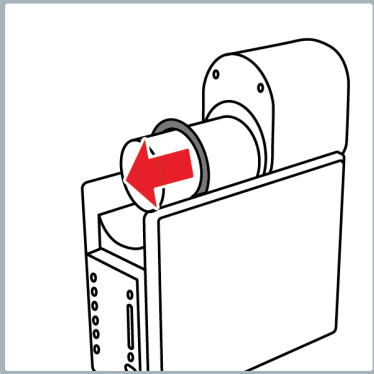

Pull the sealing ring off the cooling unit.

## 8. Pull out drawer

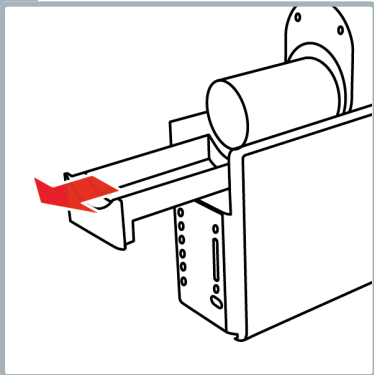

## 9. Clean accessories

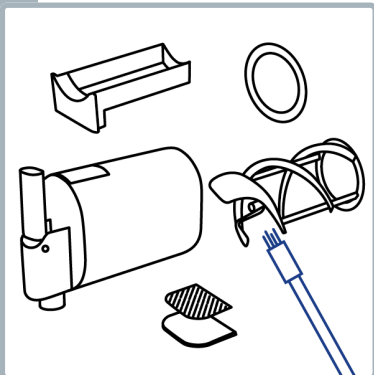

Wash the accessories under running water and with dishwashing liquid. Clean off any residues with the cleaning brush.

! Do not use anything abrasive!

i The accessories are dishwasher-safe.

## 10. Wipe off housing

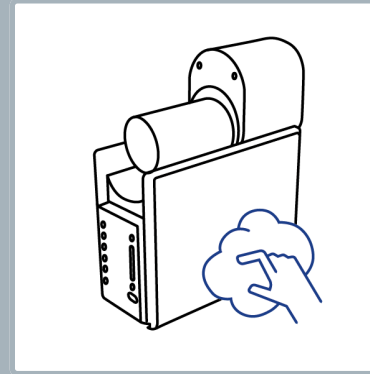

Wipe off the housing with a damp cloth.

! Never immerse the housing in water or hold it under running water.

## 11. Fit the container

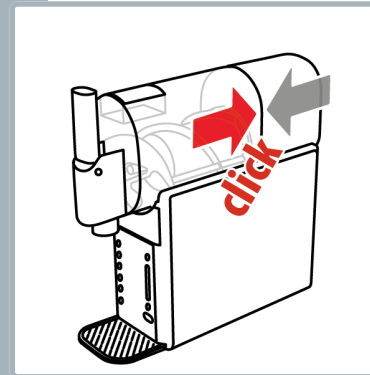

Snap the container into place until you hear a click.

# Problem and causes



Problem	Solution
Motor stuck, appliance is overloaded	Is the container too full? Is the sugar content at least 10%? Switch off the appliance and let it thaw out. Then empty the container with the Rinse programme.
Programme buttons flash	Did you install the container all the way until it clicked?
Slushie is too soft	Is there too much sugar in the mixture? Start the programme again and gradually add water or another liquid.
Slushie is too hard	Depending on the total mixture quantity, add 1-2 tbsp or 3-4 tbsp of agave syrup, another type of syrup or honey and start the programme again.
Spiked slushie separates or does not have the desired texture	Is there too much alcohol in the mixture? The alcohol content must be between 3% and 16%. Start the programme again and gradually add water or another liquid to water it down until the consistency changes.

## Problem

## Solution

---

Container overflows

Did you pour the right quantity into the container for the particular programme? The mixture may rise during processing with certain programmes.

---

Soft-serve ice cream is too soft

The sugar and/or fat content of the recipe may be too high. Reduce the temperature on the appliance and observe how the consistency of the mixture in the container changes.

---

Soft-serve ice cream is too firm

Gradually add milk (start with 1-2 tbsp), restart the programme and observe how the consistency of the mixture in the container changes. Tip: Add 1-3 tbsp of instant pudding powder to improve the consistency.

---

# User information



We provide a 5-year warranty for this device from the date of purchase. The warranty covers the replacement or repair of a device with material or manufacturing defects. Replacement with a new device or return with a refund of the purchase price is not possible. The warranty does not cover normal wear and tear, commercial use, changes to the original condition, cleaning work, consequences of improper handling or damage caused by the purchaser or third parties, damage attributable to external circumstances or damage caused by batteries. The warranty requires that the defective device be sent in at the purchaser's expense with the warranty card dated and signed by the point of sale or with the purchase receipt.



## Disposal/environmental protection

Never dispose of this device in household waste, but in accordance with local regulations. Only use official collection points in your municipality. If devices are disposed of in an uncontrolled manner, harmful substances can escape and poison the food chain, flora and fauna. Your point of sale is obliged to take back old devices. Immediately render disused devices unusable. Unplug the power plug and cut the power cord.

## Distribution

**CH** Trisa Electronics AG  
Kantonsstrasse 121  
CH-6234 Triengen  
info@trisaelectronics.ch  
+41 41 933 00 30

**DE** Ernst Lorch KG  
Bildstockstraße 9  
D-72458 Albstadt  
HG@lorch-gruppe.com  
+49 (7431) 124 200

**AT** SCD Handels GmbH  
Unterhaus 33  
A-2851 Krumbach  
service@trisaelectronics.at  
+43 (2647) 4304070

**BG** Trisa Ltd.  
43A, Gorski Patnik Street  
BG- 1421 Sofia

**5** YEARS  
GUARANTEE

